

REV.	ZONE	DESCRIPTION	DESIGN	DATE
B		NEW		

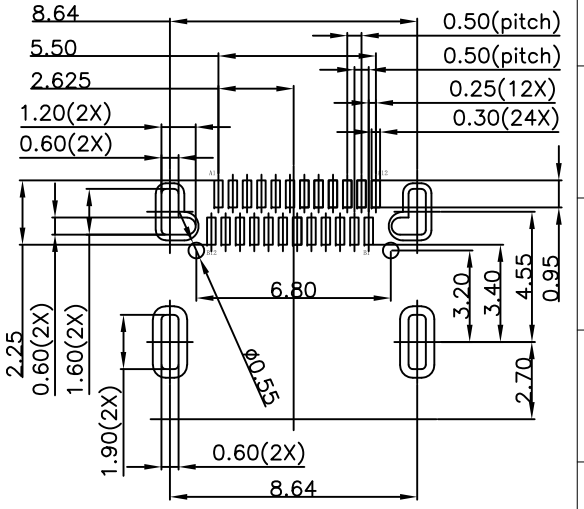

RECOMMENDED P.C.B Dimension
Tolerances: ±0.05mm

- NOTE:
- MATERIAL SPECIFICATION:
 - HOUSING: HIGH TEMPERATURE RESISTANT PLASTIC, UL94 V-0.
 - CONTACTS: COPPER ALLOY
 - MID PLATE: STAINLESS STEEL
 - FRONT SHELL: STAINLESS STEEL
 - PLATING SPECIFICATION:
 - CONTACTS:
 - Ni 50u" MIN. UNDER PLATED OVER ALL.
 - Au PLATED ON THE FUNCTIONAL AREA OF CONTACT. (GOLD PLATING THICKNESS FOLLOW THE P/N)
 - PLATING SPECIFICATIONS OF THE SOLDER AREA FOLLOW THE P/N
 - FRONT SHELL:
 - Ni 30u" MIN. UNDER PLATED OVER ALL.
 - SHIELD PLATE&EMI PLATE:
 - CLEAR ONLY
 - MECHANICAL PERFORMANCE,
 - INSERTION FORCE: 0.5~2.0kgf.
 - REMOVAL FORCE: 0.8kgf~2.0kgf.
 - DURABILITY: 10000 CYCLES.
 - ELECTRICAL PERFORMANCE,
 - CURRENT RATING: 5.0A
VOLTAGE RATING: 5.0V
 - LLCR:
 - VBUS & GND PINS AND OTHER PINS: 40mΩ/PIN MAX.
 - SHIELD: 50mΩ/MAX.
 - LLCR MAX. CHANGE OF ALL PINS: 10mΩ.
 - INSULATION RESISTANCE: 100MΩ MIN
 - DIELECTRIC WITHSTAND VOLTAGE, AC 100V FOR 1 MINUTE.
 - ENVIRONMENTAL PERFORMANCE:
 - OPERATING TEMPERATURE: -25°C~+85°C.
 - IR REFLOW:
 - THE PEAK TEMPERATURE ON THE BOARD SHALL BE MAINTAINED FOR 10 SECONDS AT 260°C.
 - SALT SPRAY TEST: 48H

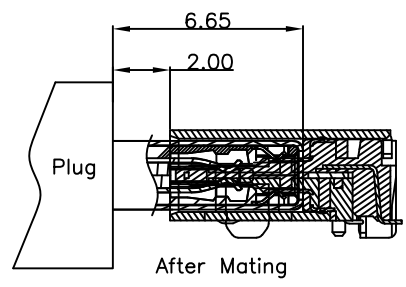
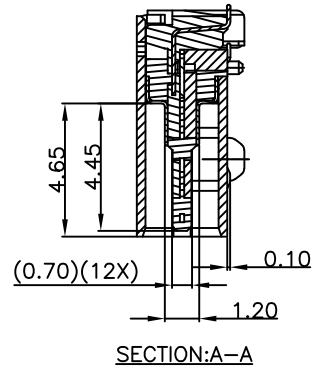
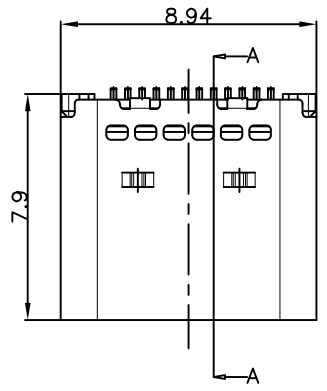
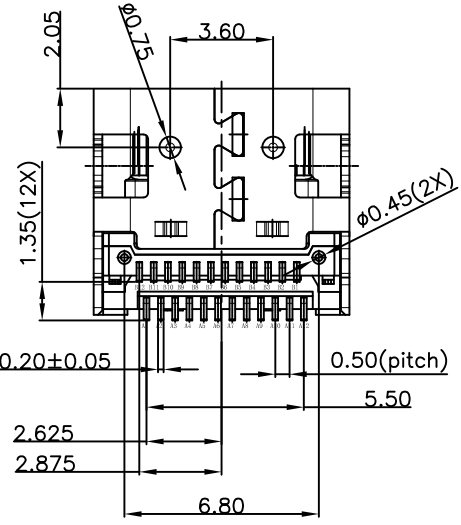
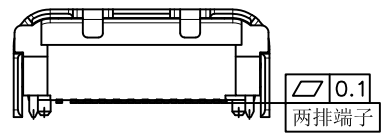
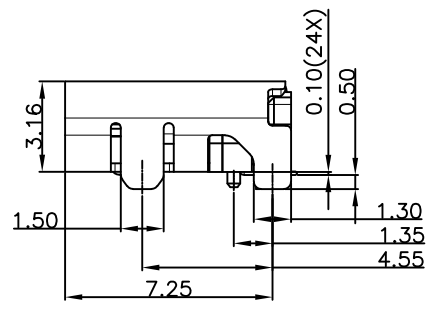
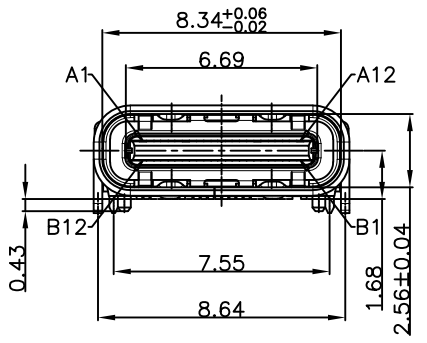

USB TYPE-C PIN ASSIGNMENTS

PIN NUMBER	SIGNAL NAME	PIN NUMBER	SIGNAL NAME
A1	GND	B12	GND
A2	SSTXp1	B11	SSRXp1
A3	SSTXn1	B10	SSRXn1
A4	VBUS	B9	VBUS
A5	CC1	B8	SBU2
A6	Dp1	B7	Dn2
A7	Dn1	B6	Dp2
A8	SBU1	B5	CC2
A9	VBUS	B4	VBUS
A10	SSRXn2	B3	SSTXn2
A11	SSRXp2	B2	SSTXp2
A12	GND	B1	GND

X.	±0.50	X.*	± 2°	UNITS	mm
.X	±0.30	.X*	± 1°		
.XX	±0.10	.XX*	± 0.5°	MAT'L	/
.XXX	±0.05				
FINISH	/	APPD:	ZHANG	Q'TY	/
CHKD:	LIJY	DR:	LINYUN		

深圳市创勤电子有限公司
SHENZHEN CHUANGQIN ELECTRONICS CO., LTD.

TITLE:
TYPE-C 24P板上双贴SMT母座 L=7.90MM 六孔(新模)

APPD: ZHANG
CHKD: LIJY
DR: LINYUN

DWG NO.:
CQ057-TFBS2479001

SCALE SHEET REV.
1/1 1/1 A1

THESE DRAWINGS AND SPECIFICATIONS ARE THE PROPERTY OF SHENZHEN CHUANGQIN TECHNOLOGY CO., LTD. AND SHALL NOT BE REPRODUCED, COPIED OR USED IN ANY MANNER WITHOUT THE PRIOR WRITTEN CONSENT OF SHENZHEN CHUANGQIN TECHNOLOGY CO., LTD.

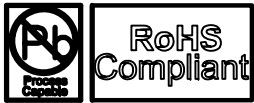

REV.	ZONE	DESCRIPTION	DESIGN	DATE
B		NEW		

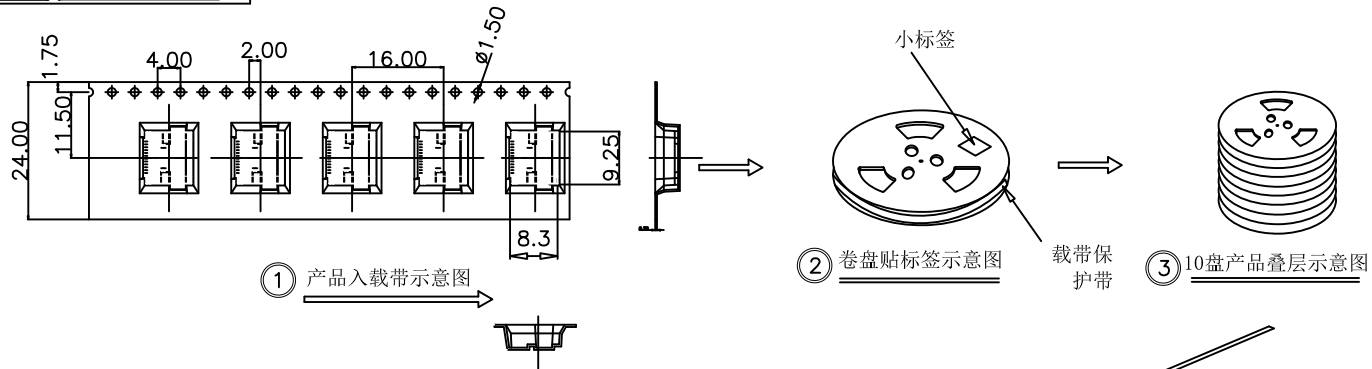

① 产品入载带示意图

② 卷盘贴标签示意图

③ 10盘产品叠层示意图

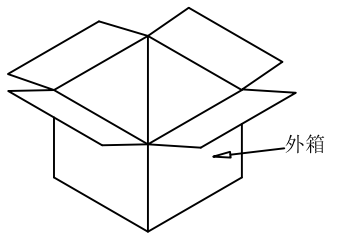

④ 产品入外箱示意图

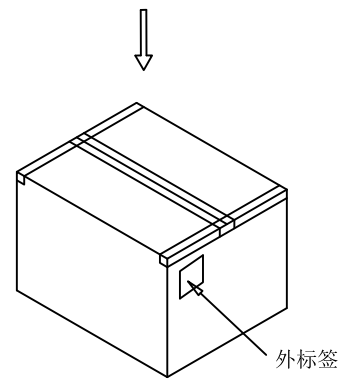

⑤ 外箱封箱示意图

NOTE:

- 1. QUANTITY/REEL: 1000 PCS
數量/卷: 1000 PCS
- QUANTITY/INNER CARTON: 1000 X 10 = 10000 PCS
數量/箱: 1000 X 10 = 10000 PCS
- 2. FREE 20 CAVE IN THE FRONT CARRIER AND FREE 20 CAVE IN THE END CARRIER.
包裝帶內圈空15格, 外圈空15格.

1	成品		C TYPE母座成品	10000
2	CARRIER TAPE	PET	W=24mm T=0.30mm	16.48M
3	COVER TAPE	PET	W=20.7mm T=0.05mm	16.48M
4	小标签		L102mm*W59mm	10
5	卷盘	PS	φ330mm*H28.4mm	10
7	外标签		L102mm*W102mm	1
9	外箱	A=A	L345mm*W345mm*H320mm	1
ITEM	DESC.	MATERIAL	REMARKS	QTY

X. ±0.50	X.° ±2°	UNITS mm	深圳市创勤电子有限公司 SHENZHEN CHUANGQIN ELECTRONICS CO., LTD.	
.X ±0.30	.X° ±1°		TITLE:	
.XX ±0.10	.XX° ±0.5°	MAT'L	TYPE-C 24P板上双贴SMT母座 L=7.90MM 六孔(新模)	
.XXX ±0.05		FINISH	APPD: ZHANG	DWG NO.:
THESE DRAWINGS AND SPECIFICATIONS ARE THE PROPERTY OF SHENZHEN CHUANGQIN TECHNOLOGY CO., LTD. AND SHALL NOT BE REPRODUCED, COPIED OR USED IN ANY MANNER WITHOUT THE PRIOR WRITTEN CONSENT OF SHENZHEN CHUANGQIN TECHNOLOGY CO., LTD.			CHKD: LIJY	CQ057-TFBS2479001
		Q'TY	DR: LINYUN	SCALE SHEET REV.
				1/1 1/1 A1